



RESILIENT / PROSERIES LUXURY VINYL FLOORING

LANGTON™ INSTALLATION & CARE GUIDE

[CLICK / GLUE DOWN](#)

Daltile | Dal-Tile Corporation
7834 C.F. Hawn Freeway
Dallas, TX 75217

TECHNICAL SERVICES
1.800.933.TILE

PROSERIES™
LUXURY VINYL FLOORING





Product Description	Grade Levels	Installation Method
Flexible Luxury Vinyl Flooring	Above, On and Below	Click Lock

CLICK LVF INSTALLATION

TOOLS REQUIRED FOR INSTALLATION

- ✓ Tape Measure
- ✓ Square Ruler
- ✓ Utility Knife
- ✓ Chalk Line
- ✓ Rubber Mallet
- ✓ Eye Protection
- ✓ Gloves
- ✓ Scrap Trapper
- ✓ Scrap Piece of LVF

ACCEPTABLE UNDERLAYMENT

LVF Click products can be installed directly over most existing floor coverings, except carpet, laminate, floating floors systems and cushioned vinyl flooring. If underlayment over subfloor is desired for added insulation and sound attenuation, install using a DalTile-approved underlayment. We recommend PAK-LITE® XPS Underlayment. See your DalTile rep for more information.

WOOD

Can be installed over virtually any sound wood underlayments or subfloors. Always fasten underlayment in accordance with the manufacturer's recommendations. For glue down applications to accommodate special needs (e.g. steps, ramps, landings, etc.), DalTile recommends underlayment grade products warranted by the manufacturer. Any failure of the underlayment or flooring as a result of the underlayment is NOT the responsibility of DalTile.

CONCRETE

Moisture levels of concrete slabs before, during and after installation must be 8 lbs. or less per 1,000 square feet per 24 hours using an anhydrous calcium chloride test according to ASTM F1869 and pH must be between 5.0 and 9.0; or, if using ASTM F2170 in-situ probes, readings should be less than

90% RH (relative humidity). In some instances, to accommodate special needs, it may be necessary to adhere the LVF to steps, ramps, landings. Refer to the DalTile LVF Glue Down instructions if adhering is necessary.

RADIANT HEAT SYSTEMS

Radiant heat systems must be approved by the manufacturer for use in resilient vinyl flooring applications. The subfloor temperature should not exceed 85°F (29°C), and the system should be turned off 24 hours prior to and after installation.

STORAGE & HANDLING

No product acclimation is required if the product temperature is between 45°F and 115°F (7°C and 46°C). Room temperature conditions must be controlled between 45°F and 115°F (7°C and 46°C) 48 hours before, during and 48 hours after installations. Cartons should be evenly stacked no more than five high on a flat surface and away from any heating/cooling ducts or direct sunlight.

SUBFLOOR & WALL/DOOR PREPARATION

NOTE: Do not install cabinets on top of floating LVF. The surface beneath the floor must be sufficiently prepared in advance to guarantee a successful installation of the flooring.

- Fill any low spots in the subfloor greater than 3/16 inch in a 10-foot span with a portland cement leveling compound.
- Ceramic tile and embossed flooring will require skim coating with a portland based patch to avoid bottom-up pattern telegraphing.

RESILIENT / PROSERIES LUXURY VINYL FLOORING

LANGTON™ INSTALLATION & CARE GUIDE

[CLICK INSTALLATION](#)



Product Description	Grade Levels	Installation Method
Flexible Luxury Vinyl Flooring	Above, On and Below	Click Lock

- Remove any existing floor molding. Removal of wall baseboards is optional as quarter round can be installed to avoid baseboard removal.
- Undercut doorjamb so the 1/4 inch expansion space is maintained, allowing the LVF to slip under doorjamb and case molding.
- Sweep the subfloor clean. The floor must also be free of all contaminants. **WARRANTY EXCLUSIONS**

WARRANTY EXCLUSIONS

Warranty exclusions apply with respect to rolling loads. In areas with frequent or heavy rolling loads, click products can be glued down to help reduce the risk of joint separation from rolling load traffic; however our warranty excludes any problems associated with rolling loads.

INSTALLATION PREPARATION & TIPS

It is the installer's responsibility to inspect the flooring prior to installation to ensure that there are no visual defects. **Do not install flooring with visible defects. If visible defects are present, contact your retailer immediately.**

- Floor must be clean, smooth, flat and dry before installation.
- Check the tongue and groove to ensure it is free of debris or damage.
- To achieve optimal appearance, mix planks from 2 to 3 cartons from the same production lot.
- DalTile LVF click products allow you to choose your own starting position and direction, working one plank or tile at a time.
- **Walls are not always straight. Snap a chalk line for your first row to follow.**

- Maintain a 1/4 inch (1/2 cm) expansion space around all walls. Quarter round or baseboard molding will cover this expansion space. **IMPORTANT:** Maintain the 1/4 inch space around cabinets, pipes, toilet flanges and any obstacle in the floor.
- For plank installation, stagger the end joints a minimum of 6 inches. For tile installation, stagger the end joints a minimum of 3 inches.

NOTE: Do not install four corners together, as this will not provide a stable installation.

CLICK INSTALLATION

Please read through the below instructions and see diagramed steps on page 5.

- To click the length joint of the plank/tile together, place long sides together, lifting slightly to engage lock. Rotate downward, clicking together for a tight fit.
- To click the end joint of the plank/tile together, click the short side of the plank/tile vertically into the previous one by pressing it by hand. Lay a piece of scrap material flat on top of the joint and tap with a rubber mallet to ensure a fully compressed, tight fit. Avoid hitting the flooring directly with the rubber mallet. Direct hits with a rubber mallet could cause damage.
- To properly seal the joint, use a small scrap of plank/tile to tap along the entire length of plank/tile. Lock the scrap piece—groove to tongue or tongue to groove—to the plank/tile requiring tightening and lightly tap the edge of the scrap. This will bring the tile edges tight together. Do not use a tapping block.
- Cut the plank/tile by scoring through the top wear layer with a utility knife, then snapping the plank/tile across the score. Install adjoining rows as you did the first, one piece at a time. Holding the plank/tile at a slight angle, place it against the

RESILIENT / PROSERIES LUXURY VINYL FLOORING

LANGTON™ INSTALLATION & CARE GUIDE

[CLICK INSTALLATION](#)



Product Description	Grade Levels	Installation Method
Flexible Luxury Vinyl Flooring	Above, On and Below	Click Lock

profile in the first row. Rotate the plank/tile down to secure the length, ensuring there are no gaps along the joint.

- The adjoining planks/tiles are aligned by sliding the long joint into position, shifting it to properly match the end joint against the previous plank/tile. Repeat until you reach the final row of material.
- The final row of planks/tiles, will usually need to be cut. Recommended method: lay a panel on top of the last row installed. Lay another plank/tile against the edge of the wall. Mark the plank/tile underneath. Cut the plank/tile through the wear layer and snap along the score. Install the last row, leaving ample expansion space. *(See Diagram A below)*

MOLDING & TRANSITIONS

For molding and transition strips, provide a 1/4 inch gap to allow expansion and contraction of the subfloor. Ensure moldings and transition strips will not pinch the flooring.

TREADS, RISERS & RAMPS

Glue down method is required on all treads, risers and wheelchair ramps, using an approved adhesive such as ProSeries LVF Universal Pressure-Sensitive Adhesive. Apply the adhesive following the manufacturer's instructions. Install the riser after installing the tread. Install stair nose moldings afterward to protect the edge of the LVF.

Diagram A

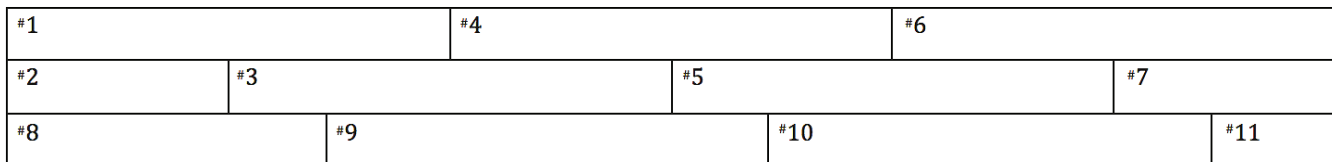

SEE NEXT PAGE FOR STEP BY STEP DIAGRAM

RESILIENT / PROSERIES LUXURY VINYL FLOORING

LANGTON™ INSTALLATION & CARE GUIDE

[CLICK INSTALLATION](#)



Product Description

Flexible Luxury Vinyl Flooring

Grade Levels

Above, On and Below

Installation Method

Click Lock

STEP BY STEP INSTRUCTIONS

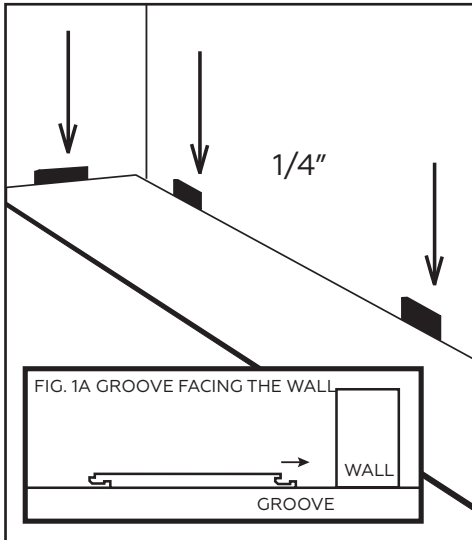

STEP 1: Choose your own starting position. Groove should face the wall (see detail FIG. 1A). Maintain 1/4" expansion gap around all walls and vertical objects.

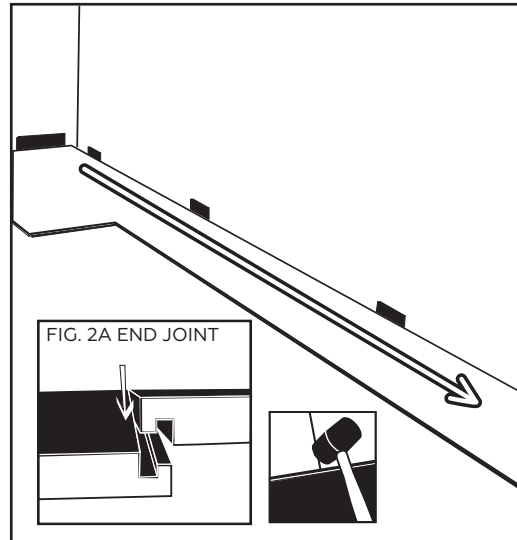

STEP 2: Click the short side of the plank vertically into the previous one by positioning it by hand followed by securing it with a rubber mallet (see detail FIG. 2A). Continue to complete a straight starter row.

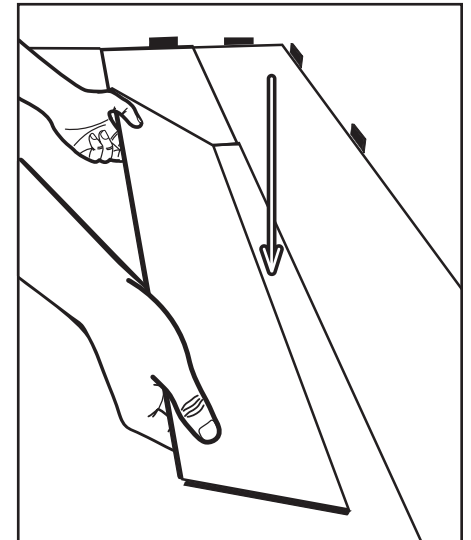

STEP 3: Place plank or tile with groove edge resting on the floor, angling the back edge slightly up approximately 4 to 5 inches.

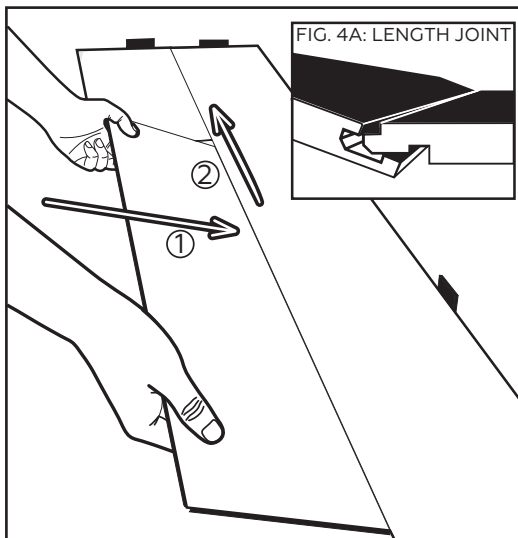

STEP 4: Second and all following rows: Slide the groove under the tongue and gently slide along the length until it aligns with the previous one (see detail FIG. 4A).

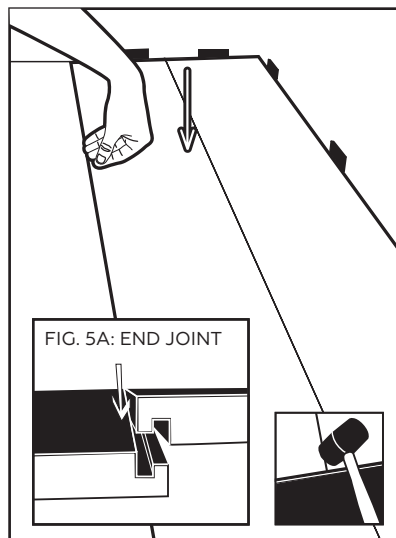

STEP 5: Position the short side of the plank vertically into the previous one with your hand followed by securing the joint using a rubber mallet.

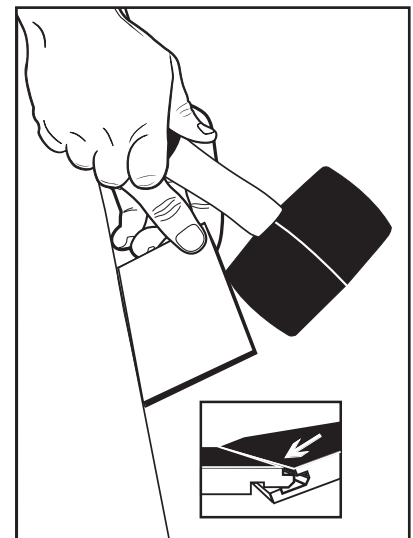

STEP 6: Once row is complete use the rubber mallet to gently tap the scrap tapper to properly secure the length joint. Repeat step 3-6 to complete your installation.



Product Description	Grade Levels	Installation Method
Flexible Luxury Vinyl Flooring	Above, On and Below	Glue Down

GLUE DOWN LVF INSTALLATION

TOOLS REQUIRED FOR INSTALLATION

- ✓ Tape Measure
- ✓ Chalk Line
- ✓ 100 lb. Roller
- ✓ Hand Roller
- ✓ Utility Knife
- ✓ U-Notch Trowel
- ✓ Square Ruler

ACCEPTABLE UNDERLAYMENT

WOOD

Wood underlayment panels require a double layer construction and must be underlayment grade as specified and warranted by the manufacturer. Always fasten underlayment panels in accordance with the manufacturer's recommendations. Any failure of the underlayment or DalTile flooring as a result of the underlayment is NOT the responsibility of DalTile. Any porous wood underlayment must be primed. *DalTile does not recommend installing resilient flooring over wood flooring or subfloors applied directly over concrete or sleeper-construction floors.*

CONCRETE

All concrete underlayments require moisture testing

Suspended: An acceptable suspended floor is a concrete substrate with a minimum of 18" (460mm) of well-ventilated air space beneath it. DalTile recommends that a moisture vapor barrier be placed on the ground below the air space.

On-Grade: An acceptable on-grade floor is a concrete substrate in direct surface contact with the ground at the surrounding ground level. The concrete slab should be protected from moisture penetration and incorporate a proven moisture vapor barrier.

Below-Grade: An acceptable below-grade floor is a concrete substrate partially or completely in contact with the ground below the average surrounding ground level. The concrete slab should be protected from moisture penetration and incorporate a proven moisture vapor barrier.

VCT

Well bonded; on and above grade; in absence of waxes or sealers

CERAMIC

Well bonded and properly prepared

TERRAZZO

Well bonded and properly prepared

SELF-LEVELING AND PATCHING COMPOUNDS

Latex fortified portland cement based only

RESILIENT

One layer; well bonded; non-cushioned

RADIANT HEATING SYSTEM

Not to exceed 85°F (29°C); approved by the manufacturer for use with vinyl flooring

UNACCEPTABLE SURFACES

- Cushion backed vinyl
- Laminate
- Interflex and any perimeter bonded products
- Carpet
- Cork
- Any floating floor system

**DalTile will not warrant or accept responsibility of any kind for flooring failures related to the use of unacceptable substrates and surfaces*

RESILIENT / PROSERIES LUXURY VINYL FLOORING

LANGTON™ INSTALLATION & CARE GUIDE

GLUE INSTALLATION



Product Description	Grade Levels	Installation Method
Flexible Luxury Vinyl Flooring	Above, On and Below	Glue Down

STORAGE & HANDLING

Acclimate the flooring for a minimum of 48 hours before installation in the area where it will be installed. Conditions between 65°F and 85°F (18°C and 29°C) are required before, during and after installation. Cartons should be evenly stacked no more than five high on a flat surface and away from any heating/cooling ducts or direct sunlight.

FLOOR PREPARATION

Floor must be clean, smooth, flat and dry. Remove all foreign substances, such as wax, grease, dirt, construction marks and contaminants, and any substance or chemical that would interfere with a good bond. Avoid using sweeping compounds. Do not install over substrates that have been chemically cleaned. Wood subfloor or underlayment must be flat, not to exceed variation of 1/4 inch in 10 feet (1/2 cm in 3 m).

The flatness of concrete subfloors must meet or exceed the requirements of ACI FF25. Fill all holes and cracks with a latex fortified portland cement based patching compound.

Daltile recommends priming extremely porous floors with an acrylic latex primer to prevent over absorption of adhesives, for dust containment, and to ensure a better bond of the adhesive to the subfloor or underlayment.

Suitability: Regardless of the type of concrete or cement-like material used as a base for Daltile LVF glue down products, the responsibility for its use or suitability rests with that product's manufacturer or specifier and not with Daltile.

Moisture Testing: It is the responsibility of the flooring contractor and the installer to test all concrete substrates, both old and new, for moisture transmission using the Calcium Chloride Moisture Test according to ASTM F1869. Moisture vapor transmission should not exceed the recommended

levels of 8 lbs. or less per 1,000 sq. ft. in 24 hours. This test should be performed and documented prior to installation. Also test for relative humidity in concrete floor slabs using in-situ probes, which should be no more than 90% RH per ASTM F2170 before, during and after installation.

These acceptable moisture readings are only applicable when using Daltile's ProSeries Universal Pressure-Sensitive Adhesive

pH Levels: pH levels on concrete substrates must be between 7 and 11.

Inspection of flooring material prior to installation is required. Any defects should be immediately reported to the retail store from which the flooring was purchased before installation. Daltile will not be responsible for labor costs to repair or replace material with defects that were apparent before or noticed at the end of an installation.

NOTE: If removal of existing resilient floor covering is required, follow all recommended Resilient Floor Covering Institute (RFCI) work practices at www.rfci.com.

Daltile only recommends the use of portland cement based products as a satisfactory patching or leveling compound for the installation of all Daltile flooring products. Common uses include:

- Leveling substrates
- Filling grooves in existing resilient floor, ceramic tile or VCT
- Filling holes
- Leveling non-water-soluble adhesives
- Filling cracks
- Filling saw cuts and/or construction joints

Do not fill actual expansion joints or other moving joints with elastomeric fillers that are designed to absorb movement in concrete slabs. Cementitious underlayment, patches and resilient flooring installed across true expansion joints will often buckle or crack when the slabs move. Usually architects will specify expansion joint covers for use with various floor coverings.

RESILIENT / PROSERIES LUXURY VINYL FLOORING

LANGTON™ INSTALLATION & CARE GUIDE

GLUE INSTALLATION



Product Description	Grade Levels	Installation Method
Flexible Luxury Vinyl Flooring	Above, On and Below	Glue Down

WARNING: For installation over old resilient floor coverings or when considering removing existing resilient floors, please be advised that these products may possibly contain asbestos fibers or crystalline silica. Please follow all recommended Resilient Floor Covering Institute (RFCI) work practices at www.rfci.com.

Cutting: Tiles and planks may be cut with a small tile cutter or scored with a utility knife and snapped.
GLUE DOWN INSTALLATION

GLUE DOWN INSTALLATION

When using planks/tiles from two or more cartons, check to be sure all pattern and lot numbers are the same to ensure proper color match. On larger installations, open several cartons and mix them as they are installed to help blend any slight shade differences from one carton to the next.

Products with directional arrows on the back should be installed with the arrows all pointing in the same direction unless you are installing custom layouts.

Before installing the material, plan the layout so plank/tile joints fall at least 6 inches (15 cm) away from subfloor and underlayment joints. Find the center point in the room. Divide the room into equal quadrants by marking two perpendicular lines on the subfloor intersecting at the center point. Depending on your layout, you may also start your row along a wall. Since walls are not always straight, snap a chalk line. Do not install over expansion joints.

DALTILE PROSERIES ADHESIVE

Use of an approved adhesive such as DalTile's ProSeries Adhesive is required for warranty to apply.

Universal Pressure-Sensitive Adhesive

ProSeries LVF Universal Pressure-Sensitive Adhesive is a very aggressive, pressure-sensitive adhesive (acrylic latex) that is designed for the installation of a wide variety of flooring types. It has been

specifically formulated to provide extended working time, develop strength quickly and perform well under rolling loads with good moisture resistance.

ProSeries Universal Pressure-Sensitive Adhesive is approved for use with luxury vinyl tile in apartments, condominiums, homes and commercial areas such as airports, malls, office buildings, restaurants, hospitals, schools, universities and government buildings.

Testing Requirements: Slabs up to 95% RH and 11 pH or less.

Adhesive Application

NOTE: Please follow DalTile ProSeries Adhesive guidelines for complete application instructions, found at daltil.com/LVF. Read all installation instructions thoroughly before installation. Refer to technical and safety data sheets for complete information regarding uses, application, limitations and safety.

1. Tools & Materials Needed: 100-lb. 3-section roller (roll both directions), hand roller, U-Notch Trowel, chalk line, carpenter square, utility knife, tape measure, in-situ RH moisture meter, pH testing kit.
2. For full spread application, use ProSeries Universal Adhesives with a 1/16" x 1/32" x 1/32" U-Notch trowel. Follow the directions on the adhesive label.
3. Spread the adhesive evenly over the subfloor, keeping the trowel at a 45-degree angle to the subfloor.
4. On nonporous substrates, allow the adhesive to remain open until trowel valleys are clear. On porous substrates, flooring can be installed into wet-tacky adhesive. Protect the open adhesive from dust and debris, which will inhibit proper bond and decrease tack.
5. Install all planks/tiles with directional arrows

RESILIENT / PROSERIES LUXURY VINYL FLOORING

LANGTON™ INSTALLATION & CARE GUIDE

GLUE INSTALLATION



Product Description	Grade Levels	Installation Method
Flexible Luxury Vinyl Flooring	Above, On and Below	Glue Down

pointing in the same direction. Install the field area first.

6. Once the flooring is installed, immediately roll the installed flooring in four directions using a 100-lb. roller. Use a hand roller under toe kicks and other hard to reach areas.
7. Clean excess adhesive & smudges from the flooring surface and tools with water while the adhesive is fresh/wet. Use mineral spirits when the adhesive is dry. **Immediately After Installation**

IMMEDIATELY AFTER INSTALLATION

Restrict to light traffic for the first 24 hours. Maintain climate settings (temperature and humidity) within installed area; do not expose to severe increases or decreases in climate. Install the base moldings. Seal all areas that may be exposed to surface spills (i.e. tubs, toilets, and showers) with silicone caulking.

TRAFFIC

- Restrict foot traffic for 12 hours after installation.
- Restrict heavy traffic, rolling loads, or furniture placement for 24 hours after installation. Additional time may be necessary if the installation is over a non-porous substrate.
- Return appliances and furniture to the room by rolling or sliding them over strips of hardboard.
- Allow at least five days following the installation before conducting wet cleaning procedures or initial maintenance.

Daltile continuously makes technological advancements that improve product performance or installation techniques and methods. All instructions and recommendations are based on the most recent information available and should be followed for an ideal installation. Contact Daltile Technical Services at 800-933-TILE with questions about product installation or visit our website at daltile.com to ensure you have the most up to date version of our installation instructions.



LANGTON™ CARE & MAINTAINANCE

Your DalTile LVF flooring will provide years of carefree use. You will find that it is not only beautiful, but durable. It is also much easier to maintain than most other flooring products, thanks to its tough protective finish and moisture resistance. It only takes a few simple care and maintenance steps to keep your DalTile floor looking beautiful for years to come.

PREVENTATIVE MAINTENANCE

- Prevent indentations and scratches with the use of non-staining floor protectors or felt pads on the legs of chairs, appliances and all heavy furniture. Floor protectors should be at least one inch in diameter.
- Do not flood floor or subject to standing water.
- Protect your floor from tracked-in dirt by using mats at all outside entrances. Mats should have a non-rubberized backing and be marked as non-staining.
- Avoid tracking in tar or asphalt from driveways.
- Avoid high heeled shoes on your floor, as they can cause permanent indentations.
- Protect your floors against burns. Burns from cigarettes, matches or other extremely hot items can cause permanent damage.
- Avoid exposure to direct sunlight for prolonged periods, as this can cause discoloration.
- Temperature within the room must be maintained between 0°F - 140°F (-18°C - 60°C). Extreme ranges between 0°F - 45°F (7°C - 46°C) and 115°F - 140°F (46°C - 60°C) apply to unoccupied environments only.

CLEANING & MAINTENANCE

- Sweep the floor regularly with a soft bristle broom to remove loose dirt.
- Wash the floor with non-abrasive, neutral pH floor cleaner.
- For every day maintenance, a mop moistened with warm water will suffice.
- Spills should be cleaned up immediately.

DO NOT USE THE FOLLOWING ON YOUR DALTILE LVF FLOOR:

- Soap based detergents
- Abrasive or mop-and-shine products
- Floor wax
- Ammonia or bleaches; for spot treatment or stain removal, use a diluted 10:1 solution of water to liquid bleach
- Vacuum cleaner with a rotating beater bar

Always read the cautionary information on all cleaners prior to use.

IMPORTANT: Never push, pull or drag furniture, appliances or other items across the floor. Always place hardboards over flooring or lift and carry furniture and other heavy items.

TREATING STAINS, SPILLS & SCUFFS

Follow the remedies in order. Unless instructed otherwise, use a clean, white cloth or towel with products recommended for DalTile LVF flooring. Always rinse the affected area with clean water after treatment.

STAIN OR SPILLS OF THIS CATEGORY:

Acids, alkalis, blood, ketchup, mustard, food, fruit, fruit juices, candy, cleaners, strong soaps,



dye, dye markings, urine and feces, grass, iodine, mercurochrome and rust

Remedy

- First, remove as much solid material as possible.
- Scrub area with cleaner at full strength.
- Rub the area with a 10:1 dilution of water to liquid bleach.
- Rub the area with isopropyl alcohol.
- If stain does not respond, use lemon juice or a cream of tartar solution.

STAIN OR SPILLS OF THIS CATEGORY:

Dried cleaning fluids, lacquer and latex paint, nail polish, solvents, oil-based paints, wood stains and varnish

Remedy

- If substance is dry, gently peel it from the floor. Avoid sharp instruments that could scratch floor.
- Scrub area with non-abrasive cleaner.
- Rub lightly with odorless mineral spirits or paint thinner.

NOTE: Do not use acetone or nail polish remover.

SUBSTANCES THAT WON'T WIPE UP:

Adhesives, chewing gum, oil, grease, candle wax and tar

Remedy

- First, remove as much solid material as possible.
- Carefully remove excess with a spoon or fingernail. Avoid sharp instruments that could scratch floor.
- Scrub area with non-abrasive cleaner.
- Rub lightly with odorless mineral spirits, isopropyl alcohol or lighter fluid.

SCUFFS AND SMUDGES:

Rubber heel marks, shoe polish

Remedy

- Rub the scuff with fingertip. The friction will remove rubber.
- Scrub area with non-abrasive cleaner.
- Rub lightly with isopropyl alcohol or lighter fluid.

CAUTION: Isopropyl alcohol, lighter fluid, odorless mineral spirits and paint thinner are flammable solvents. Carefully read and follow cautionary information on respective labels. Keep traffic off treated area for 30 minutes.

FILING A CLAIM

If you find a defect or other matter covered by any of the limited warranties described previously, promptly notify the retailer who sold you the floor covering material. The retailer will review, and if necessary file a claim with DalTile, and help answer any questions you may have.

After a warranty claim is properly filed, DalTile's service coordinator will designate a representative to evaluate the warranty claim. This warranty is conditioned upon your reasonable cooperation with DalTile and its service coordinator and representative in the evaluation of your warranty claim and the implementation of any remedy.