

# EXTERIOR BALCONY/ DECK FLOORS

Moderate Climate

Balcony or Deck Over Unoccupied Space

TCNA: F104

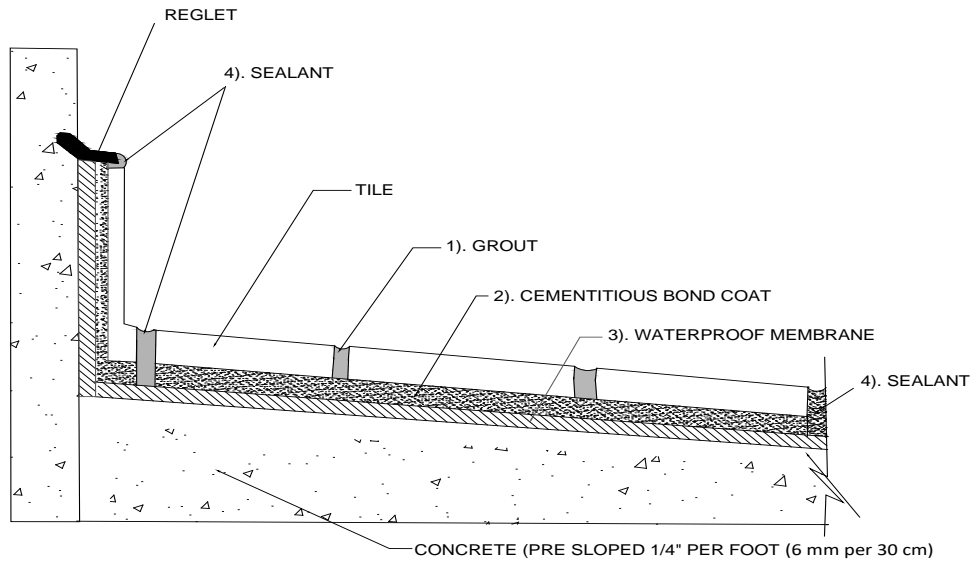

SCALE: N. T. S

## MAPEI Products Assembly

1. **Grout:**
  - A. *Ultracolor® Plus FA*
  
2. **Cementitious Bond Coat Options:**
  - A. *Ultra Flex RS ( Good)*
  - B. *Ultra Flex LFT RS (Better)*
  - C. *Grani Rapid system ( Best)*
  
3. **Waterproofing Membrane Options:**
  - A. *Mapelastic Aqua Defense (Better)*
  - B. *Mapelastic 315 (Best)*
  
4. **Flexible Sealant**
  - A. *Mapesil T Silicone Sealant*

Drawings are developed from the Tile Council of North America's (TCNA) 2016 TCNA Handbook for Ceramic Tile Installation and the Terrazzo, Tile and Marble Association of Canada's (TTMAC) Tile Installation Manual. MAPEI products are listed as options and are substituted for TCNA's and TTMAC's listed ANSI and ISO (ISO 13007) standards. Please refer to the referenced handbooks and current data sheets for complete instructions and application limitations. Some installation methods and component materials are not referenced. MAPEI encourages the user to consult all approved resources to ensure a complete assembly.

MAPEI Corporation ♦ 1144 E. Newport Center Drive ♦ Deerfield Beach, Florida 33442 ♦ Phone: 954-246-8888



## **EXTERIOR BALCONY/ DECK PAVERS**

### Balcony or Deck **Over Unoccupied Space**

Moderate Climate

1. Install waterproofing. For moderate climate use MAPEI Aqua Defense (Better) or MAPEI Mapelastic 315 (Best).
2. Install pavers using either of the mortars listed. Comb the mortar in one direction using ½” notched trowel. On the back of the paver key in the mortar and trowel with ½” notched trowel, applying the mortar in the same direction as the mortar on the substrate. Place the paver while the mortar is still plastic. Slide the paver in a back and forth motion to achieve full coverage of the mortar. Occasionally lift a paver to make sure full coverage is being achieved. Refer to Daltile for the recommended size of the grout joint. For moderate climate install with MAPEI Ultra Flex RS (Good), or MAPEI Ultra Flex LFT RS (Better), or MAPEI Granirapid System (Best).
3. After drying install grout using MAPEI Ultracolor Plus FA. Place movement joints in the finished work as per TCNA EJ171 Guideline.